

For recurring bottom (anus) itching



Class 2 OTC drug (Externally applied medicine for hemorrhoids)

- ◆ **PRESER MUZUCOOL** is a cooling ointment that is effective against hemorrhoid itching and pain. It contains five active ingredients, including chlorpheniramine maleate and lidocaine hydrochloride.
- ◆ A non-stick watery gel that spreads smoothly and adheres securely to the affected area.



Precautions for Use



Things To Consult On



- 1** The following individuals should consult with their doctor, pharmacist, or a registered seller before using this medicine
 - (1) Persons receiving treatment from a doctor.
 - (2) Persons with a history of allergic reactions caused by medicines, etc.

- 2** If any of the following symptoms appear after you have used this medicine, you may be experiencing side effects. As such, please discontinue use immediately and consult with your doctor, pharmacist or registered seller with a copy of this instruction sheet

Relevant Area	Symptoms
Skin	Rashes/redness, itching, swelling
Other	Irritation

- 3** If symptoms do not improve after approximately 10 days of using this medicine, discontinue use and consult with your doctor, pharmacist, or registered seller with a copy of this instruction sheet

Efficacy

Relief and disinfection for itching, swelling, pain, and bleeding of wart hemorrhoids and anal fistulas (bleeding hemorrhoids)

Usage/Dosage

Take an appropriate amount and apply it to the anal region one to three times a day.

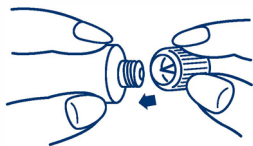

How to Open up a Hole in the Tube

Reverse the cap and press the protrusion firmly against the tip of the tube's raised neck.

- ★ Bathe or clean the affected area with warm water before use. This medicine is more effective if it is used in the morning after a bowel movement or at night before bed.

[Note]

- (1) Strictly follow the prescribed usage and dosage.
- (2) If this medicine is being used by a child, ensure it is used under the guidance and supervision of a parent or guardian.
- (3) This medicine should only be used on the anal region.
- (4) The way this medicine feels to use will vary from person to person. Those with sensitive skin or membranes may feel a strong cooling sensation. As such, start by trying only a small amount.

Components

Per 100 g

Component	Amount
Chlorpheniramine maleate	0.2 g
L-menthol	0.1 g
Lidocaine hydrochloride	3 g
Tetrahydrozoline hydrochloride	0.05 g
Benzalkonium chloride	0.05 g

Additives: Carboxyvinyl polymer, polyoxyethylene hydrogenated castor oil, pH regulator, ethanol

Precautions for Storage and Handling

- (1) Ensure the cap is tightened securely and store the medicine in a cool place that is out of direct sunlight.
- (2) Store this product out of reach of children.
- (3) Do not transfer to another container. (This may result in misuse or a change in quality)
- (4) Do not use this product beyond its expiration date. Use this medicine as soon as possible after opening, even if still within the expiration date. (In order to ensure quality)



【Disclaimer on Multilingual OTC Product Information】

- This product is a pharmaceutical product approved under a Japanese law, the Law for Ensuring the Quality, Efficacy and Safety of Drugs and Medical Devices, with a view to its sale and use in Japan.
- Multilingual product information is a translation of the product labeling written in Japanese and provided for your information only. It does not warrant that its contents and the product itself conforms to laws and regulations in countries other than Japan.
- Multilingual product information is a tentative translation by the provider (or Our Company), and may be modified or altered without notice.
- The provider (or Our Company) assumes no responsibility for any occurred problem attributable to the contents of the multilingual product information.